

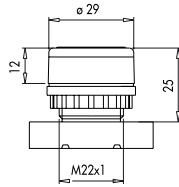

2143.01.1



2143.01.6



PLASTIC BODY

Flush, Spring Return, 22 mm

Code No	Contact Type	Color	Pcs in Box
2143.01.1	1NO	Green	10
2143.01.2	1NO	White	10
2143.01.3	1NO	Blue	10
2143.01.4	1NO	Yellow	10
2143.01.5	1NO	Black	10
2143.01.6	1NC	Red	10



2143.01.10



2143.01.12

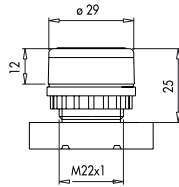

METAL BODY

Flush, Spring Return, 22 mm

Code No	Contact Type	Color	Pcs in Box
2143.01.7	1NO	White	10
2143.01.8	1NO	Blue	10
2143.01.9	1NO	Yellow	10
2143.01.10	1NO	Green	10
2143.01.11	1NO	Black	10
2143.01.12	1NC	Red	10



2143.02.1



2143.02.3

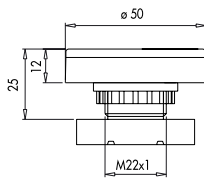

PLASTIC BODY

Double, Spring Turn, 22 mm

Code No	Contact Type	Type	Color	Pcs in Box
2143.02.1	1NO+1NC	-	Red-Green	10
2143.02.2	1NO+1NC	-	Black-White	10
2143.02.3	1NO+1NC	Extended	Red-Green	10
2143.02.4	1NO+1NC	Extended	Black-White	10



2143.02.5



2143.02.7

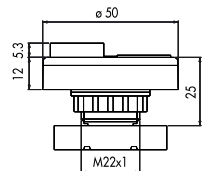

METAL BODY

Double, Spring Turn, 22 mm

Code No	Contact Type	Type	Color	Pcs in Box
2143.02.5	1NO+1NC	-	Red-Green	10
2143.02.6	1NO+1NC	-	Black-White	10
2143.02.7	1NO+1NC	Extended	Red-Green	10
2143.02.8	1NO+1NC	Extended	Black-White	10

IP65 / CONTROL UNITS

RSM

PLASTIC BODY

Selector, 22 mm

Code No	Contact Type	Type	Position	Pcs in Box
2143.03.1	1NO	Stay Put	0-1	10
2143.03.2	1NO	Spring R.	0-1	10
2143.03.3	2NO	Stay Put	2-0-1	10
2143.03.4	2NO	Single Spring R.	2-0-1	10
2143.03.5	2NO	Double Spring R.	2-0-1	10



2143.03.1

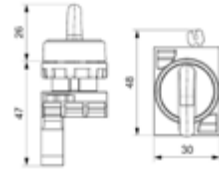

METAL BODY

Selector, 22 mm

Code No	Contact Type	Type	Position	Pcs in Box
2143.03.6	1NO	Stay Put	0-1	10
2143.03.7	1NO	Spring R.	0-1	10
2143.03.8	2NO	Stay Put	2-0-1	10
2143.03.9	2NO	Single Spring R.	2-0-1	10
2143.03.10	2NO	Double Spring R.	2-0-1	10



2143.03.6

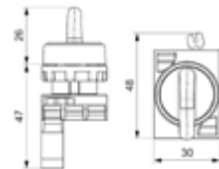

PLASTIC BODY

Emergency Stop Ø30 - Ø40 mm

Code No	Contact Type	Type	Dia.	Pcs in Box
2143.04.1	1NC	Turn to Release	40 mm	10
2143.04.2	1NC	With Label	40 mm	10
2143.04.3	1NC	Turn to Release	30 mm	10
2143.04.4	1NC	Turn to Release	30 mm	10
2143.04.5	1NC	Pull to Release	30 mm	10
2143.04.6	1NC	Pull to Release	30 mm	10
2143.04.7	1NC	With Window Pull	40 mm	10
2143.04.8	1NC	Spring Return	40 mm	10



2143.04.2



2143.04.7

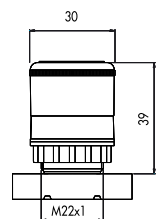

METAL BODY

Emergency Stop Ø30 - Ø40 mm

Code No	Contact Type	Type	Dia.	Pcs in Box
2143.04.9	1NC	Turn to Release	40 mm	10
2143.04.10	1NC	With Label	40 mm	10
2143.04.11	1NC	Spring Return	40 mm	10
2143.04.12	1NC	Spring Return	40 mm	10



2143.04.10



2143.04.9

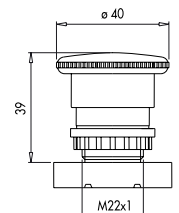



2143.05.6

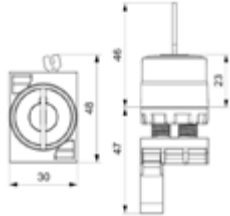

PLASTIC BODY				
Key Operated, 22 mm				
Code No	Contact Type	Type	Position	Pcs in Box
2143.05.1	1NO	Stay Put	0-1	10
2143.05.2	1NO	Spring Return	0-1	10
2143.05.3	2NO	Single Spring Return	2-0-1	10
2143.05.4	2NO	Double Spring Return	2-0-1	10
2143.05.5	1NO	Stay Put	0-1	10
2143.05.6	1NO	Stay Put	2-0-1	10



2143.05.11

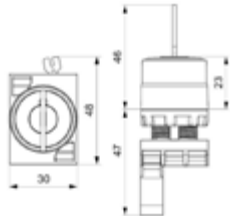

METAL BODY				
Key Operated, 22 mm				
Code No	Contact Type	Type	Position	Pcs in Box
2143.05.7	1NO	Stay Put	0-1	10
2143.05.8	1NO	Spring Return	0-1	10
2143.05.9	2NO	Single Spring Return	2-0-1	10
2143.05.10	2NO	Double Spring Return	2-0-1	10
2143.05.11	1NO	Stay Put	0-1	10
2143.05.12	1NO	Stay Put	2-0-1	10



2143.06.3

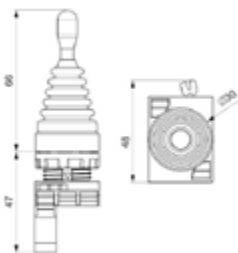

PLASTIC BODY				
Joystick, 22 mm				
Code No	Contact Type	Type	Position	Pcs in Box
2143.06.1	2NO	Stay Put	2 Pos.	1
2143.06.2	2NO	Spring Return	2 Pos.	1
2143.06.3	4NO	Stay Put	4 Pos.	1
2143.06.4	4NO	Spring Return	4 Pos.	1



2143.06.7

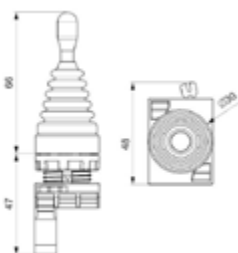

METAL BODY				
Joystick, 22 mm				
Code No	Contact Type	Type	Position	Pcs in Box
2143.06.5	2NO	Stay Put	2 Pos.	1
2143.06.6	2NO	Spring Return	2 Pos.	1
2143.06.7	4NO	Stay Put	4 Pos.	1
2143.06.8	4NO	Spring Return	4 Pos.	1

IP65 / CONTROL UNITS

IP65 Spare Parts for Control Units

Code No	Type	Features	Color	Pcs in Box
2143.07.1	Contact Block	1NO	-	20
2143.07.2	Contact Block	1NC	-	20
2143.07.3	Joystick Contact Block	2NO	-	20
2143.07.4	Illimination Block with LED	12 - 30 V AC / DC	White	20
2143.07.5	Illimination Block with LED	12 - 30 V AC / DC	Red	20
2143.07.6	Illimination Block with LED	12 - 30 V AC / DC	Blue	20
2143.07.7	Illimination Block with LED	12 - 30 V AC / DC	Yellow	20
2143.07.8	Illimination Block with LED	12 - 30 V AC / DC	Green	20
2143.07.9	Illimination Block with LED	100-230 V AC	White	20
2143.07.10	Illimination Block with LED	100-230 V AC	Red	20
2143.07.11	Illimination Block with LED	100-230 V AC	Blue	20
2143.07.12	Illimination Block with LED	100-230 V AC	Yellow	20
2143.07.13	Illimination Block with LED	100-230 V AC	Green	20
2143.07.14	Illimination Block with LED	110 V AC-DC	White	20
2143.07.15	Illimination Block with LED	110 V AC-DC	Red	20
2143.07.16	Illimination Block with LED	110 V AC-DC	Blue	20
2143.07.17	Illimination Block with LED	110 V AC-DC	Yellow	20
2143.07.18	Illimination Block with LED	110 V AC-DC	Green	20



2143.07.1



2143.07.2



2143.07.3



2143.07.5

Assembly

