

## VOLTMETER VM1-10 / VM1-11

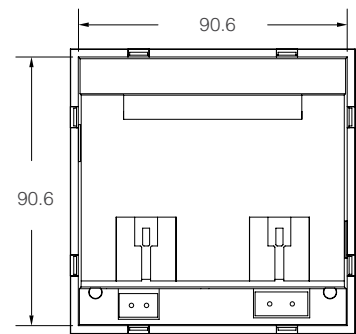

Voltmeter VM1-10

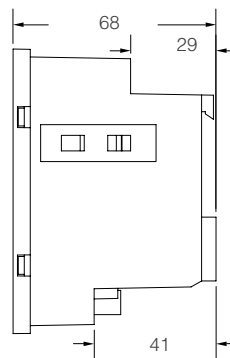
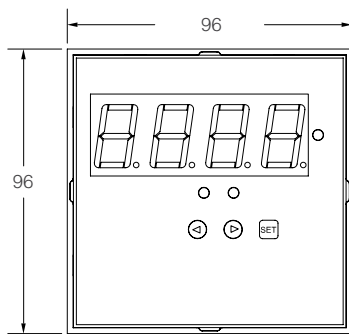

Specifications	VM1-10	VM1-11
Operating voltage	150-300V AC/DC	150-300V AC/DC
Operating frequency	50/60Hz	50/60Hz
Temperature range	-20 C° / +70 C°	-20 C° / +70 C°
Supply power consumption	< 4 VA (Maximum)	< 4 VA (Maximum)
Class	%1 ±1 digit	%1 ±1 digit
Outputs relay	-	1 pcs NO 5A 250V
Safety class	IP20	IP20
Cable thickness for terminal connection	2,5mm <sup>2</sup>	2,5mm <sup>2</sup>
Weight	< 225g	< 240g

Model No	Code No													
VM1-10	2141.03.1	●	●	●	●	●	●	●	●	●	●	●	●	●
VM1-11	2141.03.2	●	●	●	●	●	●	●	●	●	●	●	●	●
		Single-phase Current	Max. Voltage	Min. Voltage	Contact Output (single relay)	Over/Low protection	Voltage Transformer Ratio	96X96	Panel Type	Rail Type	1 Display 4 Digit	150-300V AC/DC Feeding		

## MULTIMETER / AMMETER / VOLTMETER

The logo for RSM, consisting of the letters 'RSM' in a bold, red, sans-serif font, enclosed within a red square border that is open on the top and right sides.

### MULTIMETER / AMMETER / VOLTMETER

Product Name	Code No	Pcs in Box	Pcs Pack.
MT3-20	2141.01.1	1	12
MT3-21	2141.01.2	1	12
MT3-22	2141.01.3	1	12
MT3-22C	2141.01.4	1	12
MT6-22C	2141.01.5	1	12
AM1-10	2141.02.1	1	12
AM1-10AT	2141.02.2	1	12
AM1-11	2141.02.3	1	12
VM1-10	2141.03.1	1	12
VM1-11	2141.03.2	1	12
VMT-21	2141.03.3	1	12